

Self-centring vice for small parts

centrinos

GRESSEL



Modular Structure

Despite of its compact length of only 170 mm, centrinos provides a large clamping range.

Work-pieces and parts ranging in size from 0 – 152 mm can be held with clamping forces up to 20 kN with a torque of only 65 Nm.

centrinos can be used to clamp raw materials or as a precision vice with an accuracy to within 0.02 mm. The standard version can be enhanced by the addition of raised 5-axis basic jaws for optimum access and with the appropriate attachment jaws.

Fully covered

Due to its specially developed slide geometry with guideways of 150 mm length, centrinos is the first truly covered self-centring vice. Malfunction due to dirt and chips belong to the past.

Operation from both sides

The design of the centrinos allows it to be operated from either side.

Base integrated directly into palette

The unique new design enables centrinos to be integrated directly into exchange palettes, such as EROWA or System 3R, without the need for a base plate. This is not only advantageous in terms of saving weight and costs, but also reduces the height of the unit and thereby increasing its stability.

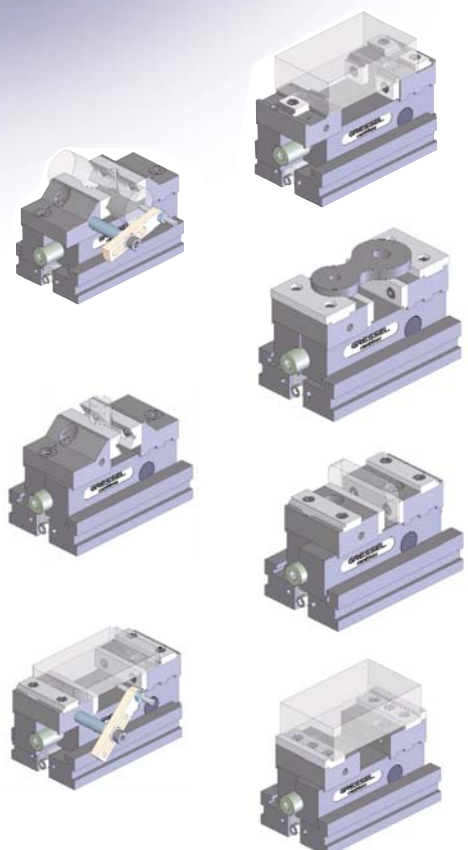
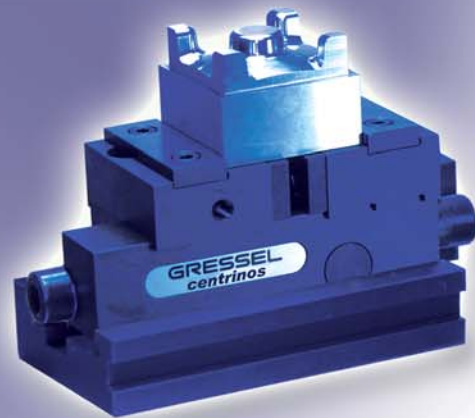

centrinos Self-centring vice for small parts

centrinos

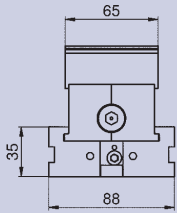

Standard Version

Examples of Standard Version

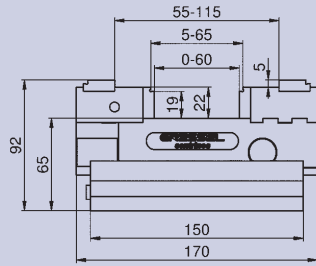

Universal stepped jaw (smooth)

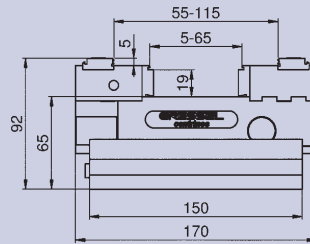

Grip jaw 22 (reversible)

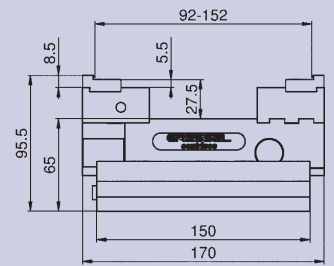

VS grip jaw (horizontal)

centrinos

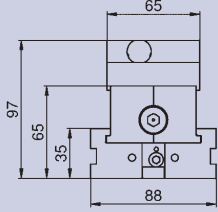

5A Version

Examples of 5A Version

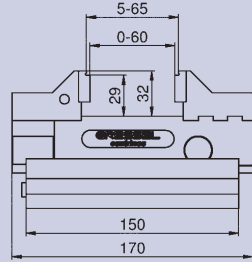

Universal stepped jaw (smooth)

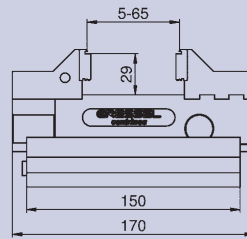

Grip jaw 22 (reversible)

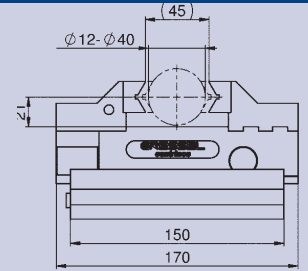

Prism jaw (ground)

Type	Description	Jaw width [mm]	Clamping force [kN]	Weight [kg]	Order No.
Standard version	without attachment jaws	65	max. 20	6.3	CSM.065.001.01
5A version	including raised basic jaw, without att. jaws	65	max. 20	6.3	CSM.065.101.01

Delivery contents: centrinos, including 8 screws for attachment jaws. Attachment jaws to be ordered separately

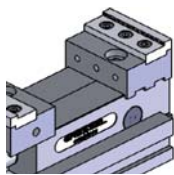

VS grip jaw
for extended clamping range up to 152 mm

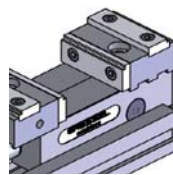

Universal step jaw (smooth), reversible
can be installed vertically or horizontally

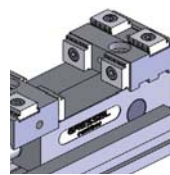

Grip jaw 22, reversible
can be installed vertically or horizontally

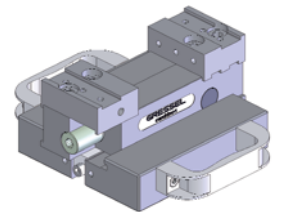

centrinos-IP
fully integrated into palette

Fully covered makes the unit resistant to dirt and chips

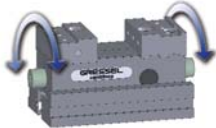

Operation possible from both sides

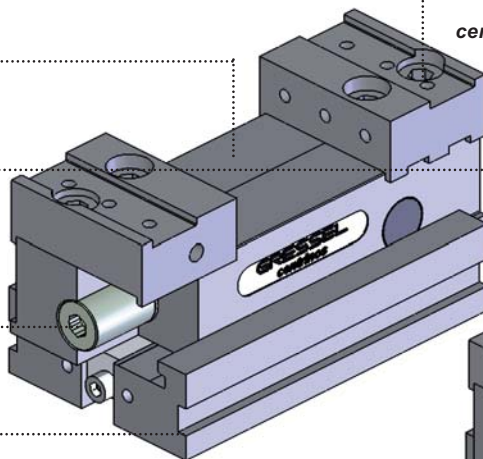

centrinos

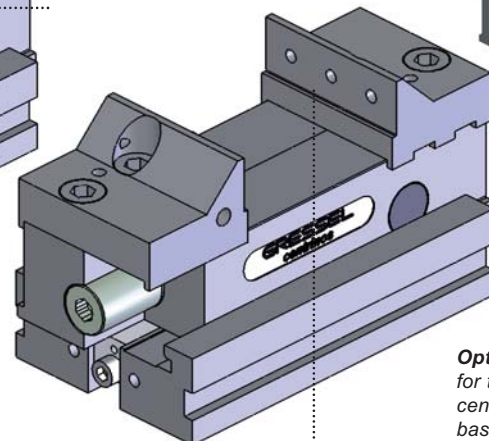

centrinos 5A

Extra-long guide-ways of 150 mm allow great precision and the use of clamping forces of up to 20 kN

Optimal access for tools with centrinos 5A raised basic jaws

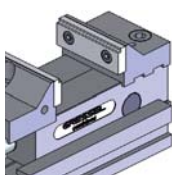

Universal stepped jaw (smooth)

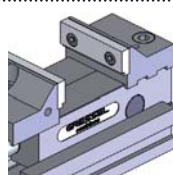

Smooth jaw

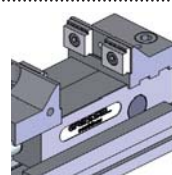

Grip jaw 22, reversible

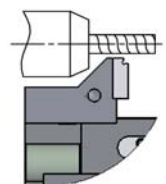

Assortment of jaw types

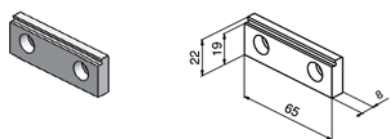

Type	Description	Qty.	Order No.
Universal stepped jaw (smooth)	Step 3 mm	1 piece	CSA.065.002.11

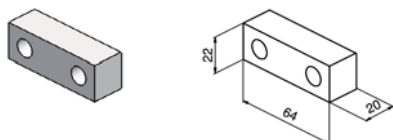

Type	Description	Qty.	Order No.
Vertical jaw (soft)	for vertical installation only	1 piece	FSA.065.037.11

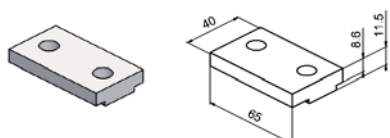

Type	Description	Qty.	Order No.
Horizontal jaw (soft)	for horizontal installation only	1 piece	CSA.065.008.11

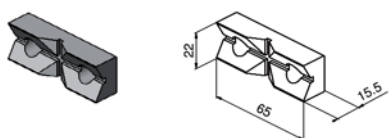

Type	Description	Qty.	Order No.
Prism jaw (ground)	horizontal and vertical prism jaw	1 piece	CSA.065.007.11

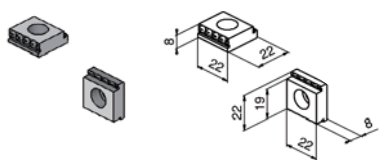

Type	Description	Qty.	Order No.
Grip jaw 22 (reversible)	22 x 22 mm / step grip 3 mm	1 piece	CSA.065.005.11

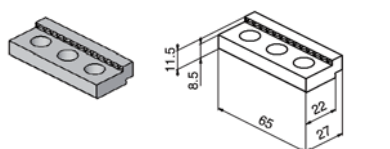

Type	Description	Qty.	Order No.
VS grip jaw	VS = increased clamping range for horizontal installation only	1 piece	CSA.065.006.11

Additional jaws and customized jaws are available on request

Accessories



Type	Description	Qty.	Order No.
Work-piece stop		1 piece	FSA.000.010.01



Type	Description	Qty.	Order No.
Torque wrench	20 - 100 Nm with readable scale	1 piece	XNF.91101.016

Delivery contents: Torque wrench including an Allen key SW8 and ratchet



Alignment and clamping elements

Type	Description	Order No.
Set for breadboard M12	1 x milled locating pin $\varnothing 12$ g6 / $\varnothing 8$ 1 x cylindrical locating pin $\varnothing 12$ g6 / $\varnothing 8$ 1 x hexagonal bolt M12	CSA.000.001.01
Set for T-groove 12 mm	2 x cylindrical locating pin $\varnothing 12$ g6 / $\varnothing 8$ 1 x hexagonal bolt M10 1 x washer 1 x T-slide 12 mm, M10	CSA.000.002.01
Set for T-groove 14 mm	2 x cylindrical locating pin $\varnothing 14$ g6 / $\varnothing 8$ 1 x hexagonal bolt M12 1 x T-slide 14 mm, M12	CSA.000.003.01

Alignment and clamping elements for additional dimensions available on request

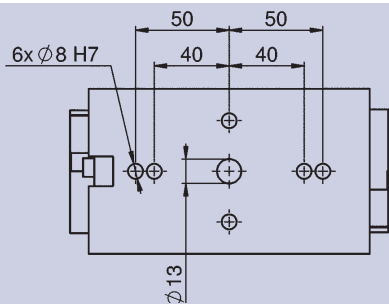

Standard Base plate dimensions

centrinos-IP

The holes for the clamping bolt in the palette can be made in accordance with selected the zero point clamping system.

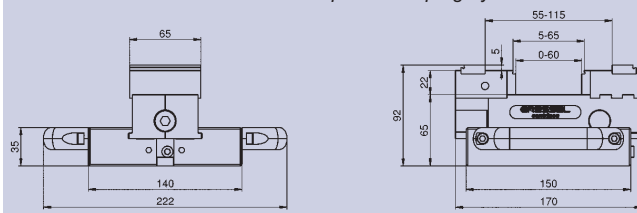

Palette 140 mm x 150 mm

Applications

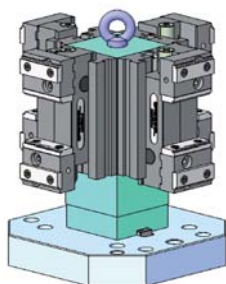

Tower

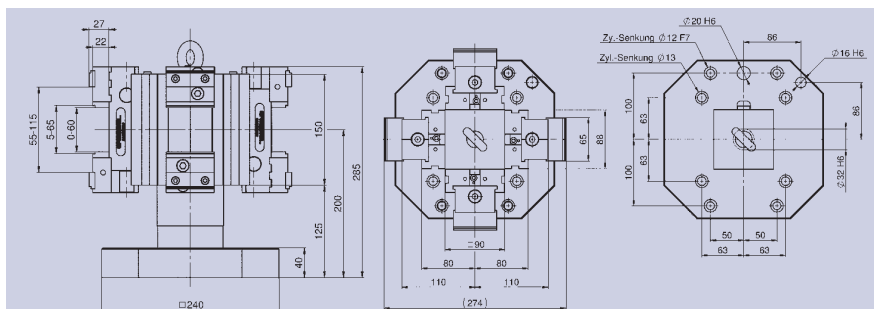

Lateral view

Basic dimensions

We are happy to advise you regarding complete solutions.
Please contact us for more information.

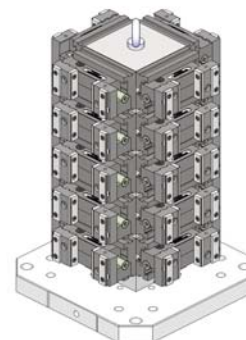
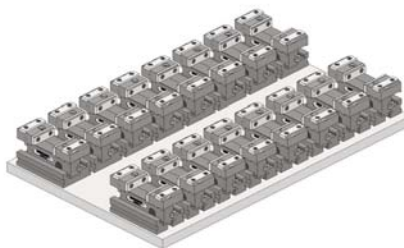
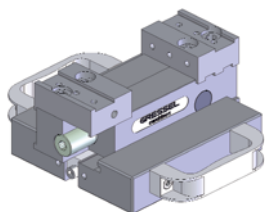
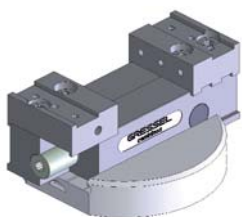

Clamping force diagram

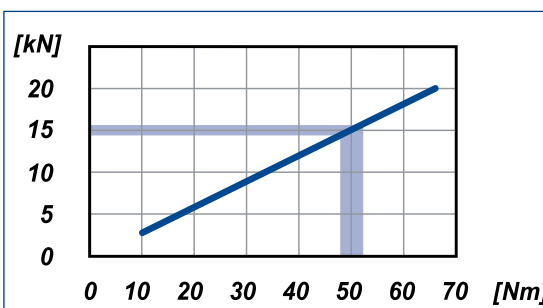

Optimal operating range:

Clamping force: 15 kN

Torque: 50 Nm

Sales

GRESSEL AG
Spanntechnik
Schützenstrasse 25
CH-8355 Aadorf
Schweiz
Tel. +41 (0)52 368 16 16
Fax +41 (0)52 368 16 17

info@gressel.ch

www.gressel.ch